



# MASTER LEDcandle DiamondSpark

## MASTER LEDcandle DT 6-40W E14 BA38 CL

Delivering incandescent-like sparkling light effects, MASTER LEDcandle bulbs are ideal for general and decorative lighting in the hospitality industry, as well as in home environments. The dimmable MASTER LEDcandles drive further efficiencies, while helping to create the desired atmosphere. Mounted in full view in chandeliers, wall scones or modern luminaires, the clear or frosted glass bulbs fit all existing fixtures with an E14 and B15 socket. Drawing upon inputs from chandelier makers and designed to enhance the aesthetic appeal of the chandelier or luminaire, not only when lit but also when not, these lamps come in a classical slender shape with a unique, eye-catching lens design. They produce a beautiful sparkling warm light that delivers huge energy savings and minimizes maintenance cost. The flame-shaped candle lamps comes in a classical slender shape with a unique, eye-catching lens design that perfectly complements modern LED candles.

### Product data

General Information	
Cap base	E14 [ E14]
EU RoHS compliant	Yes
Nominal lifetime (nom.)	25000 h
Switching cycle	50,000X
Technical type	6-40W
Light Technical	
Colour Code	822-827 [ tunable warm white]
Luminous flux (nom.)	470 lm
Colour designation	Warm white (WW)
Correlated Colour Temperature (Nom)	- K
Luminous efficacy (rated) (nom.)	75 lm/W

Colour consistency	<6
Color rendering index (nom.)	80
LLMF at end of nominal lifetime (nom.)	70 %
Operating and Electrical	
Input frequency	50 to 60 Hz
Power (Rated) (Nom)	6 W
Lamp current (nom.)	35 mA
Wattage equivalent	40 W
Starting time (nom.)	0.5 s
Warm-up time to 60% light (nom.)	0.5 s
Power factor (nom.)	0.7

# MASTER LEDcandle DiamondSpark

Voltage (Nom)	220-240 V
<b>Temperature</b>	
T-Case maximum (nom.)	95 °C
<b>Controls and Dimming</b>	
Dimmable	Yes
<b>Mechanical and Housing</b>	
Lamp Finish	Clear
<b>Approval and Application</b>	
Energy efficiency label (EEL)	A+
Suitable for accent lighting	No

Energy consumption kWh/1,000 hours	6 kWh
<b>Product Data</b>	
Full product code	871869645354400
Order product name	MASTER LEDcandle DT 6-40W E14 BA38 CL
EAN/UPC – product	8718696453544
Order code	45354400
Local order code	MLED6WCANDT14FL
SAP numerator – quantity per pack	1
SAP numerator – packs per outer box	10
Material no. (12 NC)	929001140502
SAP net weight (piece)	0.063 kg

## Dimensional drawing

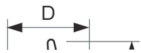

Product	D	C
MASTER LEDcandle DT 6-40W E14 BA38 CL	38 mm	129 mm

Candle BA38 220-240V 6W-40W 2700K E14 DT

## Photometric data

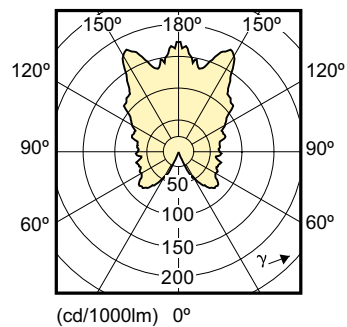

SDLD\_LEDCL\_0030-Light distribution diagram

## MASTER LEDcandle DiamondSpark

