



Coreline tempo X-Large

BVP140 LED420-4S 36K1/740 PSD S D9

CORELINE TEMPO X-LARGE - LED module 42000 lm - 740 neutral white - Symmetrical

Coreline tempo X-Large delivers on the Coreline promise of innovative, easy to use and high quality luminaires; Designed to be a plug-and-play 1:1 retrofit of conventional floodlights with short payback time, its extensive options open a lot more opportunities to optimise performance and savings in many different applications, such as recreational sports facilities, industrial/commercial areas, car parks, etc.; This floodlight is equipped with the QR code-based Philips Service tag, which supports installation and maintenance work and enables you to create your digital library of lighting assets and spare parts.; As an option, Coreline tempo X-Large is also ready to be connected to lighting asset management systems, such as Interact City and Interact Sports recreational

Product data

| General Information | | Connection | Connection unit 5-pole |
|-------------------------------|--|----------------------|---|
| Lamp family code | LED420 [LED module 42000 lm] | Cable | Cable 1.0 m with plug Wieland/Adels compatible 5-pole |
| Light source colour | 740 neutral white | Protection class IEC | Safety class I |
| Light source replaceable | Yes | Flammability mark | D [For mounting on easily flammable surfaces] |
| Number of gear units | 2 units | CE mark | CE mark |
| Driver/power unit/transformer | PSD [Power supply unit with DALI interface] | ENEC mark | ENEC plus mark |
| Driver included | Yes | Warranty period | 5 years |
| Optical cover/lens type | FG [Flat glass] | Optic type outdoor | Symmetrical |
| Luminaire light beam spread | 73° x 26° | | |
| Control interface | DALI | | |

Coreline tempo X-Large

| | |
|---|--|
| Remarks | * At extreme ambient temperatures the luminaire might automatically dim down to protect components |
| Constant light output | No |
| Number of products on MCB (16 A type B) | 4 |
| EU RoHS compliant | Yes |
| Light source engine type | LED |
| Serviceability class | Class C, luminaire without serviceable parts, not serviceable |
| Product family code | BVP140 [CORELINE TEMPO X-LARGE] |

Light Technical

| | |
|--------------------------------|----|
| Upward light output ratio | 0 |
| Standard tilt angle post-top | 0° |
| Standard tilt angle side entry | 0° |

Operating and Electrical

| | |
|---------------------|--------------|
| Input Voltage | 220 to 240 V |
| Input frequency | 50 to 60 Hz |
| Inrush current | 53 A |
| Inrush time | 0.3 ms |
| Power factor (min.) | 0.99 |

Controls and Dimming

| | |
|----------|-----|
| Dimmable | Yes |
|----------|-----|

Mechanical and Housing

| | |
|-------------------------------------|--|
| Housing material | Aluminium die-cast |
| Reflector material | - |
| Optic material | Acrylate |
| Optical cover/lens material | Glass |
| Fixation material | Steel |
| Mounting device | MBA [Mounting bracket adjustable] |
| Optical cover/lens shape | Flat |
| Optical cover/lens finish | Clear |
| Overall length | 540 mm |
| Overall width | 560 mm |
| Overall height | 70 mm |
| Effective projected area | 0.26 m ² |
| Colour | Grey |
| Dimensions (height x width x depth) | 70 x 560 x 540 mm (2.8 x 22 x 21.3 in) |

Approval and Application

| | |
|-------------------------|---|
| Ingress protection code | IP66 [Dust penetration-protected, jet-proof] |
|-------------------------|---|

| | |
|--|------------------------------|
| Mech. impact protection code | IK08 [5 J vandal-protected] |
| Surge protection (common/differential) | - |

Initial Performance (IEC Compliant)

| | |
|--|----------------------|
| Initial luminous flux (system flux) | 36120 lm |
| Luminous flux tolerance | +/-7% |
| Initial LED luminaire efficacy | 144 lm/W |
| Init. Corr. Colour Temperature | 4000 K |
| Init. Colour rendering index | >70 |
| Initial chromaticity | (0.38, 0.38) SDCM <5 |
| Initial input power | 250 W |
| Power consumption tolerance | +/-11% |
| Init. colour rendering index tolerance | +/-2 |

Over Time Performance (IEC Compliant)

| | |
|---|-------|
| Control gear failure rate at median useful life 75,000 h | 7.6 % |
| Control gear failure rate at median useful life 100,000 h | 10 % |
| Lumen maintenance at median useful life* 75,000 h | L90 |
| Lumen maintenance at median useful life* 100,000 h | L96 |

Application Conditions

| | |
|------------------------------------|---------------|
| Ambient temperature range | -40 to +50 °C |
| Performance ambient temperature Tq | 25 °C |
| Maximum dimming level | 10% |

Product Data

| | |
|-----------------------------------|------------------------------------|
| Full product code | 871869987291500 |
| Order product name | BVP140 LED420-4S 36K1/740 PSD S D9 |
| EAN/UPC – product | 8718699872915 |
| Order code | 87291500 |
| SAP numerator – quantity per pack | 1 |
| Numerator – packs per outer box | 1 |
| SAP material | 912300024347 |
| SAP net weight (piece) | 17.000 kg |



Coreline tempo X-Large

Dimensional drawing

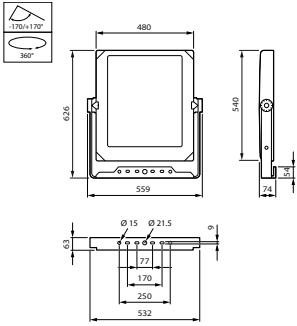

CoreLine Tempo BVP110/120/125/130/140

Photometric data

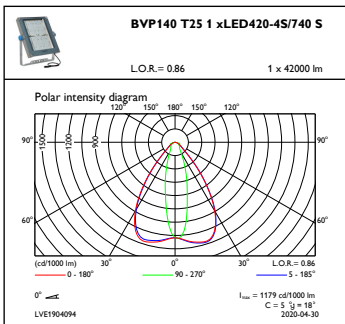

OFPC1_BVP140T251xLED420-4S740S

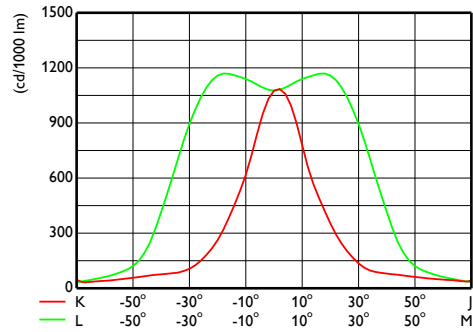

OFCS1_BVP140T251xLED420-4S740S

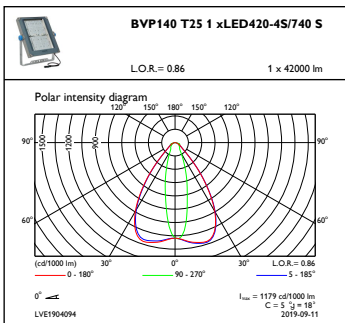

OFPC1_BVP140T251xLED420-4S740S

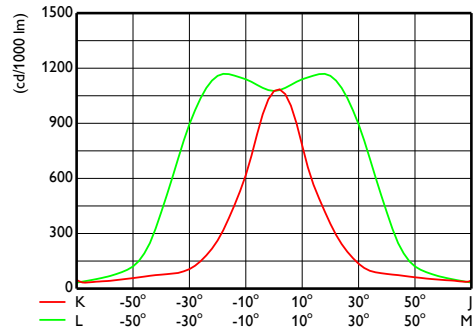

OFCS1_BVP140T251xLED420-4S740S

Coreline tempo X-Large

